



George Lovell Drive, Enfield Island Village, EN3

Offers In The Region Of £469,999

 4  2  1  C

George Lovell Drive, Enfield Island Village, EN3



Description

****CUL-de-SAC LOCATION**** Homelink are delighted to be the vendors chosen sole agents in offering this lovely and well presented FOUR DOUBLE BEDROOM End of Terrace Townhouse set over 3 floors.

Benefits include a great sized kitchen/breakfast/dining room with modern fitted modern kitchen, four good size bedrooms, two full size bathrooms including an en-suite to the master bedroom, spacious lounge with balcony, storage, double glazed windows, gas central heating, pleasant rear garden and a single garage in a bloc to the rear.

The property is situated in a highly sought-after plot in the ENFIELD ISLAND VILLAGE. The development was built at the turn of the century and benefits from an on-site Gym, Tesco Supermarket, Library, Children's Playgrounds, Bus stops and a 10-15 minutes' walk to Enfield Lock Train Station which has good links into London.

Tenure: Freehold
Enfield C/Tax Band - E

- THREE STOREY TOWNHOUSE
- FOUR DOUBLE BEDROOMS
- TWO TILED BATHROOMS
- SPACIOUS KITCHEN/DINER
- LOW MAINTENANCE GARDEN
- SINGLE REAR GARAGE IN BLOC
- GREAT TRANSPORT LINKS
- CLOSE TO LOCAL AMENITIES
- IDEAL FOR GROWING FAMILY
- CHAIN FREE





Floor Plan

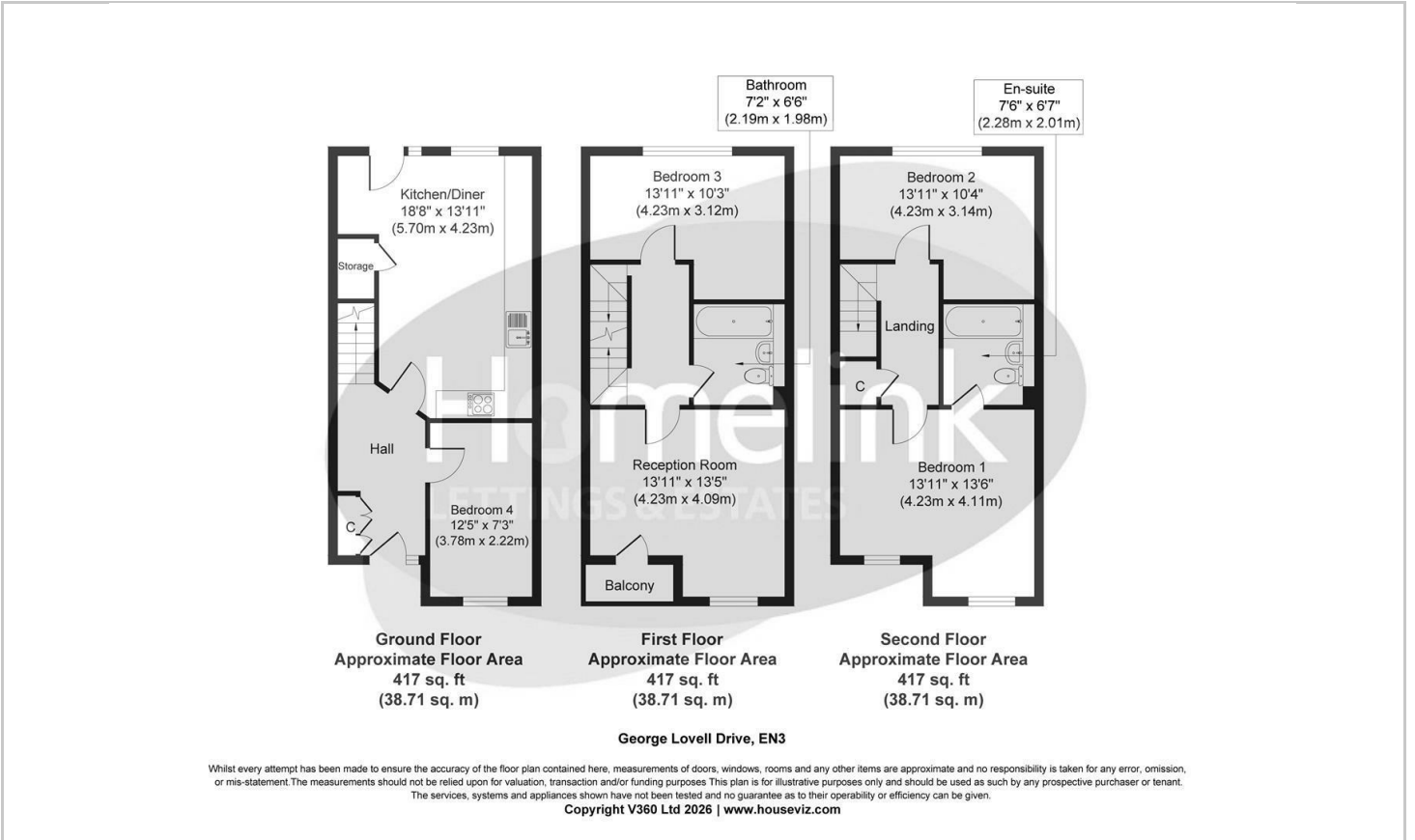

Area Map

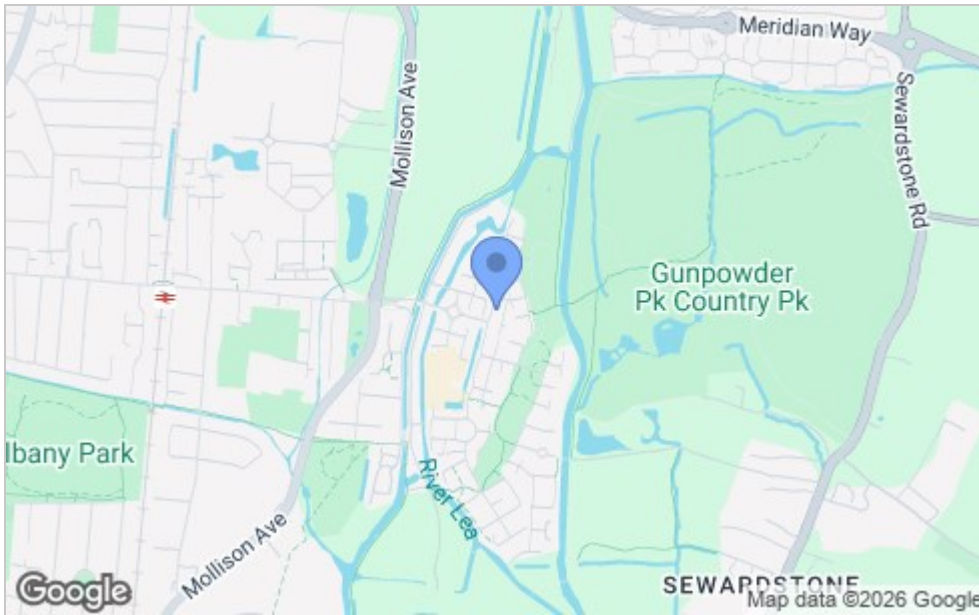

Viewing

Please contact our Homelink Lettings & Estates Office on 0208 882 2112 if you wish to arrange a viewing appointment for this property or require further information.

These particulars, whilst believed to be accurate are set out as a general outline only for guidance and do not constitute any part of an offer or contract. Intending purchasers should not rely on them as statements of representation of fact, but must satisfy themselves by inspection or otherwise as to their accuracy. No person in this firm's employment has the authority to make or give any representation or warranty in respect of the property.

Energy Efficiency Graph

